

PRODUCT- TJM TWIN COMPRESSOR MOUNTING BRACKET

VEHICLE- 150 SERIES PRADO 2013+

PART NUMBER- JBA-CB212, JBA-CB212KIT2, JBA-CB212KIT3

ESTIMATED FIT TIME

- | | |
|--|--------------|
| - REMOVAL AND REFIT OF SEAT AND INTERIOR PANELS | 60 MINS |
| - REMOVAL AND REFIT OF DRAWER SYSTEM (IF REQUIRED) | 60-90 MINS |
| - PREPARING AND MOUNTING COMPRESSOR | 60 MINS |
| - WIRING COMPRESSOR AND MOUNTING SWITCH | 120-180 MINS |

IMPORTANT NOTES

- READ INSTRUCTIONS CAREFULLY PRIOR TO FITMENT
- ENSURE 567 THREAD SEALANT IS APPLIED TO ALL AIR THREADS INSTALLED
- ENSURE THAT ALL TRIM CLIPS ARE REMOVED FROM THE VEHICLE WHEN REMOVING PANELS AND RE-INSERTED BACK INTO THE PANELS BEFORE RE-INSTALLATION (SEE STEPS 1.21-1.23).
- REFER TO TJM COMPRESSOR INSTALLATION INSTRUCTIONS FOR WIRING SPECIFICATIONS
- NITTO FITTING USED WITH KITS 2 AND 3 SUPPLIED WITH TJM AIRLINE KIT (013COMPKN) SUPPLIED SEPERATLEY (NOT BY JBA) AVAILABLE THROUGH TJM STORES

KIT CONTENTS

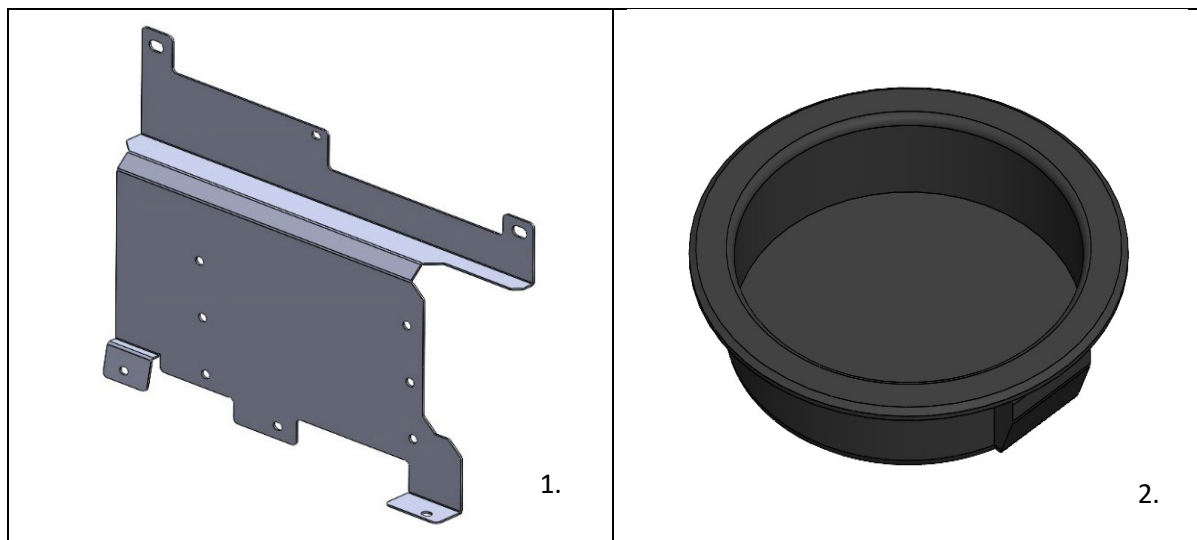

ITEM	DESCRIPTION	PART NO.	QTY
1	150 SERIES SINGLE COMPRESSOR BRACKET	10-CB212A	1
2	150 SERIES WHEEL ARCH INFILL	10-CB212WAI	1
3	M10 X 25MM SEMS ASSEMBLY ZY	JNS-78	2
4	M6 x 20MM SEMS ASSMEMBLY Z/Y	B48 0620ZY	3
5	M8 X 16MM HEX HEAD SET SCREW GR 8.8 316 S/S	X07 80168.8316	6
6	5/16 X 3/4 X 18G FLAT WASHER GR 304 S/S	X79 082018G304	12
7	M8 NYLON INSERT LOCK NUT GR 304S/S	X53 8304	6

OPTIONAL PARTS- KIT CONTENTS

JBA-CB212QASF QUARTER PANEL AIR/SWITCH/FUSE OUTLET BRACKET (JBA-CB212KIT)

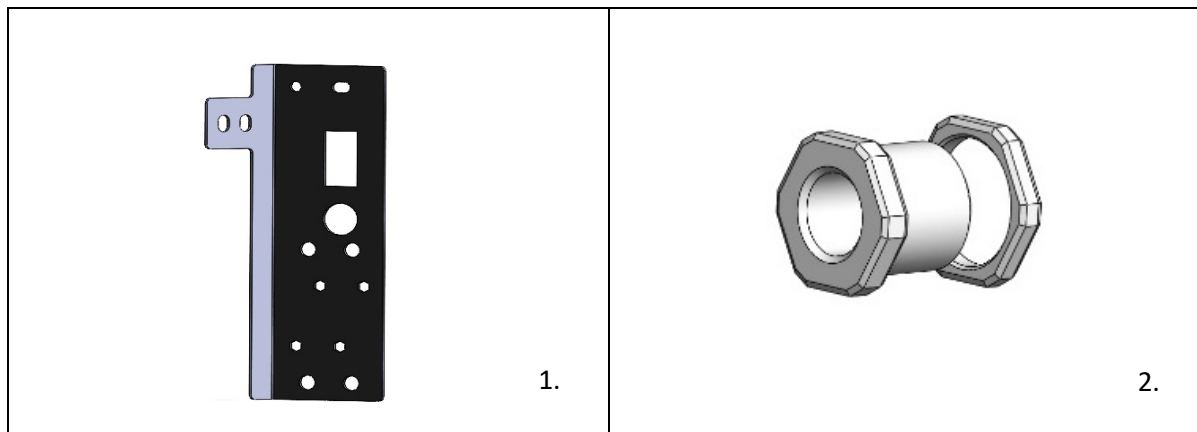

ITEM	DESCRIPTION	PART NO.	QTY
1	150 SERIES SINGLE AIR/SWITCH/FUSE BRACKET	10-CB212QASF	1
2	JBA COMPRESSOR BULK HEAD AND NUT	JBA-CB103	1
3	M6 x 20MM SEMS ASSMEMBLY Z/Y	N24 06ZY	2
4	M6 HEX SERR FLANGE NUT ZY	X07 80168.8316	2
5	M4 X 12MM PAN HD PHIL M/T GR 304 S/S	X37 0412PP304	4
6	10MM2 6MM STUD FLARED ENTRY CABLE LUG	57120	4
7	20MM HEAT SHRINK RED 6.4MM	ACX1275	4

JBA-CB212QF QUARTER PANEL FUSE BRACKET (JBA-CB212KIT3)

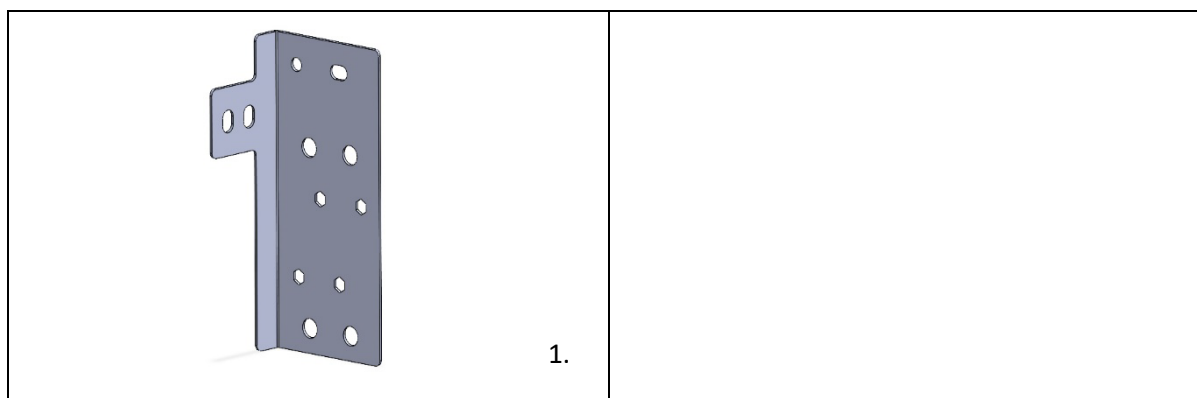

ITEM	DESCRIPTION	PART NO.	QTY
1	150 SERIES SINGLE FUSE BRACKET	10-CB212QF	1
3	M6 x 20MM SEMS ASSMEMBLY Z/Y	N24 06ZY	2
4	M6 HEX SERR FLANGE NUT ZY	X07 80168.8316	2
5	M4 X 12MM PAN HD PHIL M/T GR 304 S/S	X37 0412PP304	4
6	16MM2 6MM STUD FLARED ENTRY CABLE LUG	57124	4
7	20MM HEAT SHRINK RED 9MM	ACX1277	4

1. PREPARING THE VEHICLE- REMOVING THE SEATS

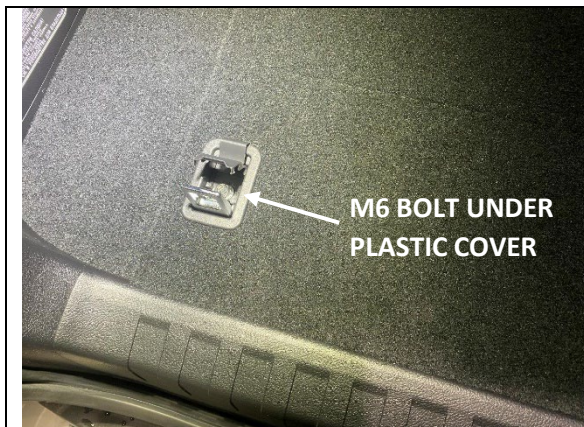

STEP 1.1 POP OPEN 2 X REAR TIE DOWNS AND REMOVE M6 BOLTS UNDER PLASTIC COVER. REMOVE TIE DOWNS AND KEEP ASIDE.

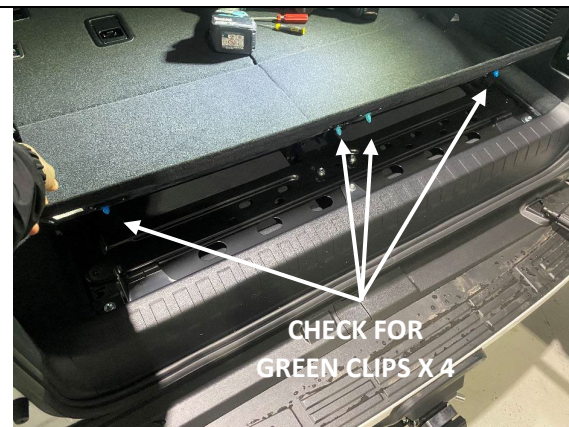

STEP 1.2 PULL UP PANEL FROM REAR OF VEHICLE. MAY NEED A BIT OF FORCE. CHECK GREEN CLIPS COME OUT AND STAY IN PANEL.

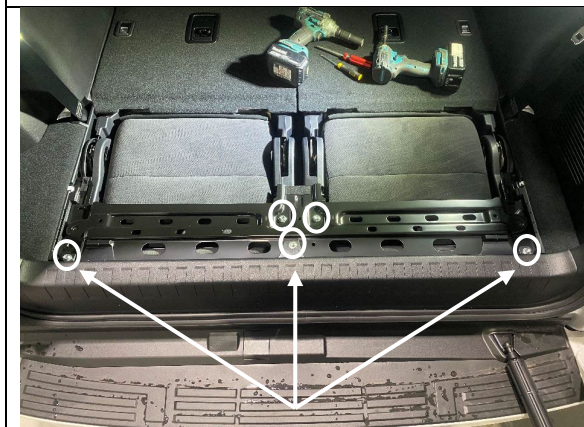

STEP 1.3 REMOVE 5 X M6 BOLTS FROM BLACK STEEL BRACKET AND KEEP ASIDE FOR LATER.



STEP 1.4 PULL OUT THE REAR PLASTIC TRIM AS SHOWN AND SET ASIDE. AGAIN, A BIT OF FORCE MAY BE REQUIRED TO REMOVE. CHECK FOR TRIM CLIPS.



STEP 1.5 PULL THE SIDE PANELS OUT FROM EITHER SIDE AS SHOWN. CHECK TRIM CLIPS STAY IN PANEL.



STEP 1.6 REMOVE BLACK STEEL BRACKET AND SET ASIDE.

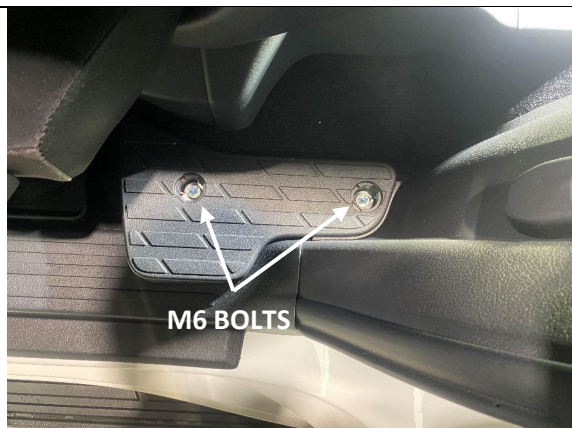

STEP 1.7 MOVE TO THE SECOND ROW OF SEATS ON THE PASSENGER SIDE AND FOLD/SLIDE FORWARD. REMOVE PLASTIC CAPS AND REMOVE M6 SCREWS ON SIDE TRIM AS SHOWN

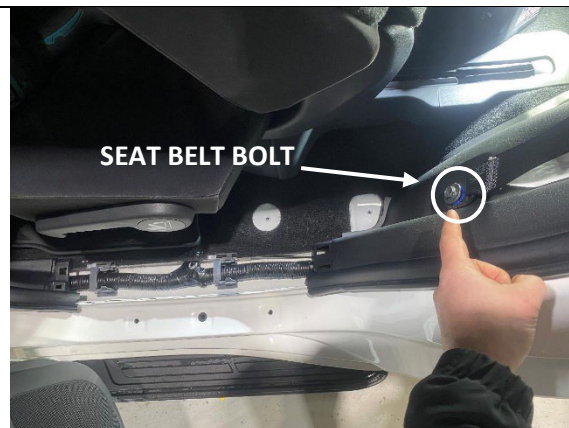

STEP 1.8 PULL UP DOOR TRIM PANEL AS SHOWN CHECKING FOR BODY CLIPS. REMOVE SEAT BELT BOLT COVER AND UNDO 14MM BOLT.



STEP 1.9 REMOVE 2 TRIM COVERS ON GRAB HANDLE AND REMOVE M6 SCREWS.

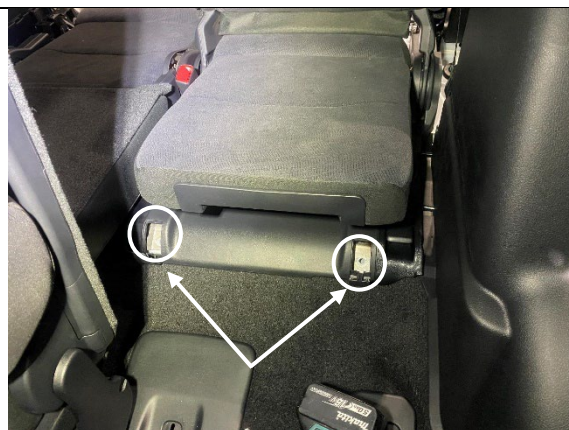

STEP 1.10 POP OPEN PLASTIC VOVERS AND REMOVE 2 X 14MM BOLTS. RELEASE 3RD ROW SEAT AND BRING FORWARD AS SHOWN.

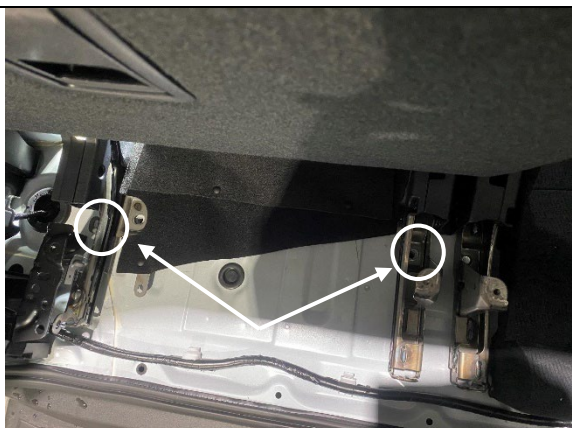

STEP 1.11 MOVE BACK AROUND TO THE REAR OF THE CAR AND REMOVE 2 X 14MM BOLTS.



STEP 1.12 REMOVE 2 X M6 BOLTS AND REMOVE BLACK STEEL BRACKET AND SET ASIDE AS SHOWN.



STEP 1.13 THE PASSENGER SIDE 3RD ROW SEAT CAN NOW BE COMPLETELY REMOVED. PULL OUT AND SET ASIDE.



STEP 1.14 REMOVE 14MM BOLT ON SEAT BELT AS SHOWN.



STEP 1.15 REMOVE 2 X PHILLIPS HEAD SCREWS AT BASE OF REAR QUARTER PANEL.



STEP 1.16 TWIST REAR PLASTIC CAP 90 DEGREES AND REMOVE. REMOVE M6 PHILLIPS HEAD SCREW EXPOSED.



STEP 1.17 REMOVE PLASTIC COVER AS SHOWN AND REMOVE M6 SCREW AS SHOWN.



STEP 1.18 PULL BACK RUBBER SEAL AND BEGIN PULLING BACK QUARTER PANEL AS SHOWN. CHECK FOR TRIM CLIPS AGAIN.

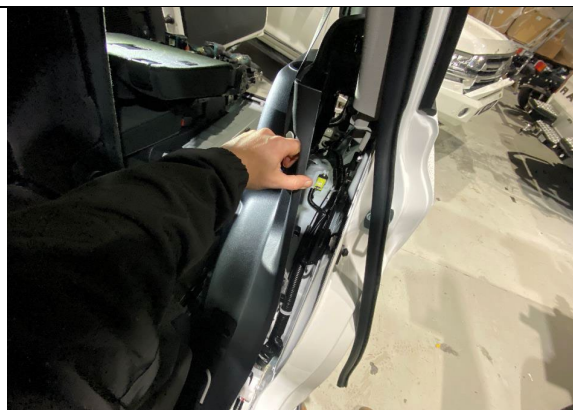

STEP 1.19 MOVE TO THE SECOND ROW PASSENGER DOOR AND BEGIN PULLING BACK QUARTER PANEL AGAIN CHECKING TRIM CLIPS.



STEP 1.20 FULLY REMOVE QUARTER PANEL GENTLY AND SET ASIDE. CHECK FOR TRIM CLIPS (REFER TO STEPS 1.21-1.23 BELOW)

REFERENCE PICS FOR TRIM CLIPS



STEP 1.21 REFERENCE PICS FOR TRIM CLIP (EXAMPLE ONLY). AS YOU ARE REMOVING PANELS, KEEP NOTICE OF ANY CLIPS THAT HAVE REMAINED IN THE VEHICLE- NORMALLY WHITE OR GREEN AS SHOWN.



STEP 1.22 USE A TRIM CLIP REMOVER TO POP OUT OF THE VEHICLE AS SHOWN.



STEP 1.23 RE-INSERT INTO THE PLASTIC TRIM PANEL LOCATION. THEY WILL NORMALLY SLIDE IN AND POP INTO POSITION. THESE STEPS WILL ENSURE AN EASIER RE-INSTALLATION OF THE PANELS LATER.

2. REMOVING SUBWOOFER (IF REQUIRED)

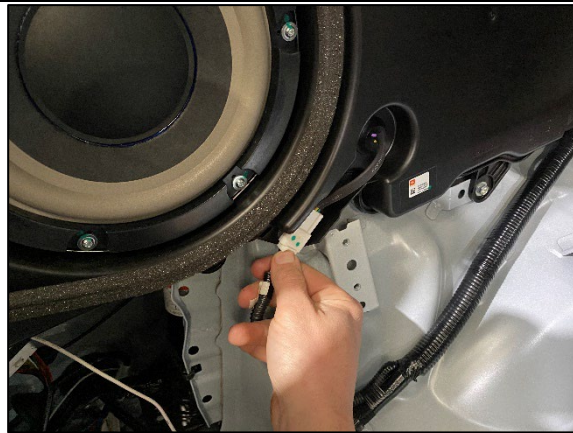

STEP 2.1 REMOVE PLUG FROM BOTTOM WHERE SHOWN



STEP 2.2 REMOVE THE 4 X M6 SCREWS AND KEEP SPEAKER ASIDE. SCREWS NOT REQUIRED LATER INSTALL, KEEP WITH SPEAKER.

3. PREPARING COMPRESSOR



STEP 3.1. FIT THE TJM COMPRESSOR TO THE BRACKET IN THE ORIENTATION SHOWN USING M8 X 16 BOLTS WITH WASHER UNDER THE HEAD. FASTEN FROM THE REAR OF THE BRACKET USING WASHER AND M8 NYLOC NUTS. RUN COMPRESSOR WIRING TO LEFT OR RIGHT DEPENDING ON WHERE POWER CABLE HAS BEEN RUN FROM.

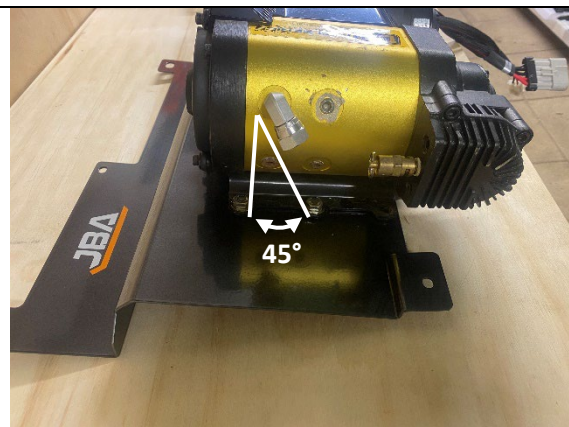

STEP 3.2. IF FITTING OPTIONAL AIR OUTLETS IN KIT2 OR KIT 3, FIT THE JBA-CB106 90 DEGREE ELBOW TO THE TOP SIDE OF THE COMPRESSOR AS SHOWN. ENSURE ELBOW IS FITTED USING 567 THREAD SEALANT AND ORIENTATED 45 DEGREES AS SHOWN.

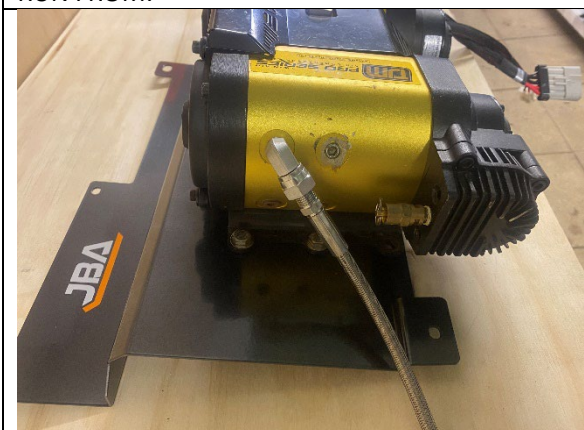

STEP 3.3 FIT JBA STAINLESS HOSE USING 567 THREAD SEALANT IN PREPARATION FOR AIR OUTLET INSTALLATION LATER.

4. INSTALLATION INTO VEHICLE



STEP 4.1 REMOVE M6 NUT ON WHEEL ARCH STUD AND KEEP ASIDE. REMOVE VEHICLE WIRING HARNESS FROM STUD.



STEP 4.2. POSITION BRACKET INTO VEHICLE LOCATING THE BOTTOM RIGHT HOLE OVER THE STUD ON THE WHEEL ARCH. INSTALL M6 X 20 SEMS TOP LEFT AND M10 X 20 TOP RIGHT ON BRACKET FINGER TIGHT.



STEP 4.3. INSTALL TWO M6 X 20 SEMS ON BOTTOM LEFT AND CENTRE INTO CAPTIVE NUT ON WHEEL ARCH.



STEP 4.4 RE INSTALL THE VEHICLE WIRING HARNESS AND M6 NUT ON WHEEL ARCH STUD REMOVED IN STEP 4.1 AS SHOWN. TIGHTEN ALL FASTENERS FULLY AT THIS STAGE.

5. PREPERATION AND INSTALLATION OF OPTIONAL QUARTER PANEL FUSE/AIR/SWITCH PANEL (JBA-CB212QASF/JBA-CB212F)

JBA-CB212QASF INSTALL INSTRUCTIONS SHOWN FOR AIR/SWITCH/FUSE INSTALL. IF FITTING AIR OULET TO DRAWER FRONT (JBA-CB101) OR TOWBAR (JBA-TB113), REFER TO SEPARATE INSTRUCTIONS SUPPLIED WITH THESE PARTS FOR MOUNTING AND USE JBA-CB212F FUSE MOUNT. IF FITTING SWITCH TO DRAWER FRONT USE JBA-CB901 AND EXTEND WIRING AS REQUIRED.



STEP 5.1 INSTALL CARLING SWITCH AND ANS-H FUSE HOLDERS (SUPPLIED WITH TJM COMPRESSOR) USING M4 X 12 SCREWS. INSTALL JBA-CB103 BULK HEAD AS SHOWN, APPLY THREAD SEALANT TO NUT FROM BEHIND.

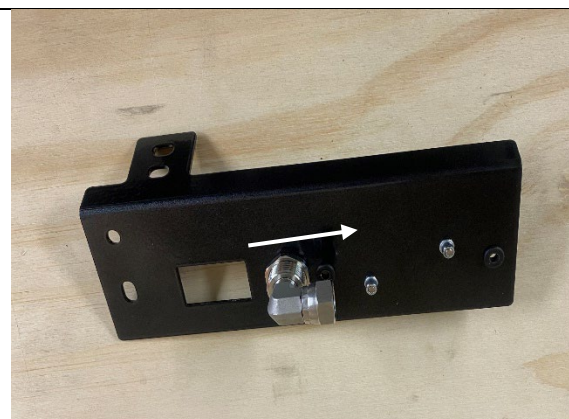

STEP 5.2 FIT JBA-CB106 90 DEGREE ELBOW USING 567 THREAD SEALANT. ENSURE OUTLET IS FACING TOWARDS THE BOTTOM OF THE BRACKET AS SHOWN. INSTALL TJM NITTO FITTING (SUPPLIED IN 013COMPKN) USING 567 THREAD SEALANT TO FRONT OF BULK HEAD.

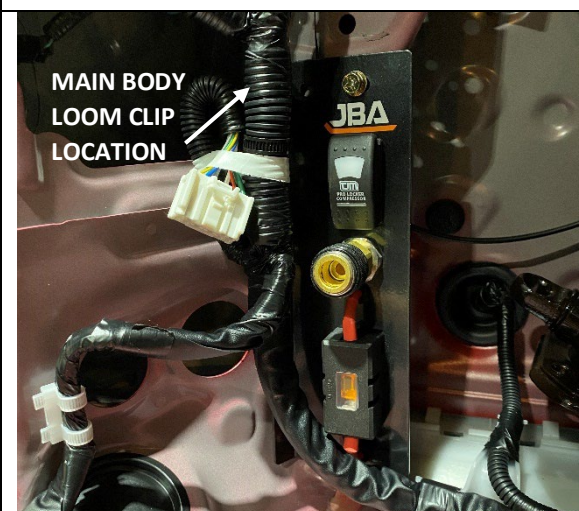

STEP 5.3 REMOVE THE MAIN BODY LOOM BODY CLIP AND POSITION BRACKET IN PLACE. RECLIP BODY LOOM INTO SLOT IN BRACKET AND FASTEN BRACKET INTO ORIGINAL BODY CLIP LOCATION USING M6 X 20 SEMS AND M6 FLANGE NUT.

6. FINAL STEPS



STEP 6.1 NEATLY CABLE TIE AND LOOSE LOOMS OR AIR LINES AND TRIM. TEST ALL AIR CONNECTIONS FOR AIR LEAKS AND CYCLE COMPRESSOR CHECKING ELECTRICAL FUNCTIONALITY.



STEP 6.2 LOOSELY SIT REAR QUARTER PANEL BACK INTO VEHICLE AND REMOVE CUP HOLDER FROM WHEEL ARCH



STEP 6.3 INSERT JBA WHEEL ARCH INFILL AS SHOWN



STEP 6.4 REFIT REAR QUARTER PANEL AND SEATS REFERING TO STEPS 1.1-1.20 ABOVE IF REQUIRED. VACUUM AND WIPE DOWN ALL SURFACES.